

**Knelson Concentrator Model
 KC-MD3
 Specification Sheet**

Maximum Feed Capacity	- 45 kg/hr Solids
Maximum Total Volumetric Throughput	- 8L/min (2USgpm)
Feed Size	- Maximum: 2mm
Feed Density	- 0 - 75% Solids by weight
Concentrator Installation Weight	- 28kg (61lbs) (Including DC drive)
Motor	- 0.2kW (1/4HP) - Electric

Cone Style	Fluidization Water Lpm (USgpm)	Concentrate Weight g (lb)	G-Force Range G's
MD3 Cone	0.7 (0.2) - 4.5 (1.1)	80 (0.18) - 150 (0.33)	40 - 200

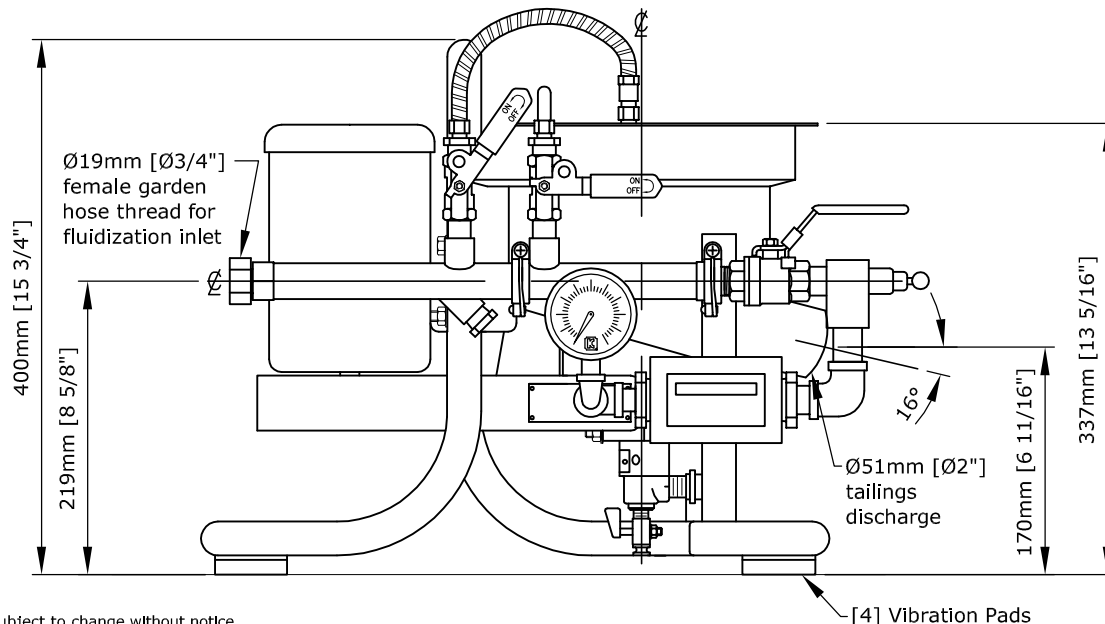
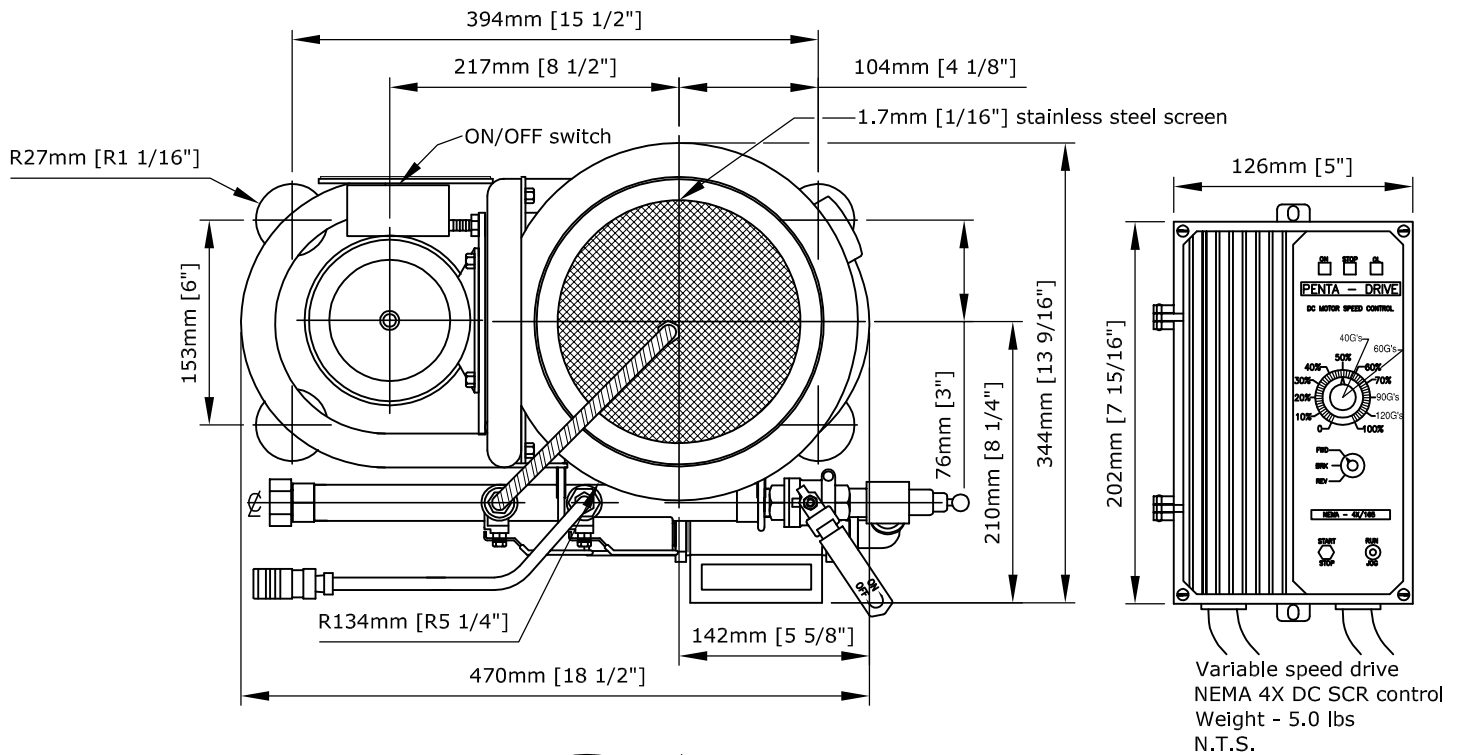

Note:
 - Specifications subject to change without notice.
 - All piping to concentrator to be flexible to allow for slight oscillation of unit during operation.
 - Consult FLSmidth Knelson for more detailed operating parameters for your specific application.